



SPACE - DIRECT LEASE

3 Manhattanville Road

Purchase, NY | Westchester
www.thecentreatpurchase.com

DETAIL

Floor/Suite	2 / Suite 203
Total SF	6,625
Rent	\$32.00
Available	Immediate
Use	Office

CONTACT

Peter S. Duncan - President and CEO
Phone 212-481-1122

Dana R. Pike - Senior Vice President
Phone 212-542-2116

Andrew Joseph - Vice President
Phone 212-481-1122 Ext 2123



BUILDING DESCRIPTION

The distinctive combination of amenities and total ease of access from virtually any point in Westchester County and beyond create a truly Class A corporate campus. The Centre at Purchase consists of one 3-story and three 4-story office buildings. The 43-acre corporate campus includes abundant parking, gourmet cafe, professional gym, and onsite management. The centrally located pond features fountains, picnic tables, and bridges for all the tenants to enjoy.

MAJOR TENANTS

Central National Gottesman; National Realty & Development Corp; Stroz Friedberg, LLC

AMENITIES

ATM machine. Attractive landscaped grounds. Balconies. Café. Conference facility. Courtyard. Covered parking. Dry cleaner. Exercise facility. Express bus to train. High speed internet. Mailroom. On-site management. Overnight mail (Fedex, Airborne, UPS, etc.). Picnic areas. Pond. Private corporate setting.

OTHER BUILDING INFO

Building Area: 104,875 sf **Number of Floors:** 3 **Floor Sizes:** Typical Floor Size 32,700 rsf **Ceiling Height:** 12'0" **Manager:** George Comfort & Sons Inc. **Year Built/Renovated:** Built: 1990 **Tenancy:** Multi-tenant **Building Class:** A **Primary Type:** Office **Property Status:** Existing

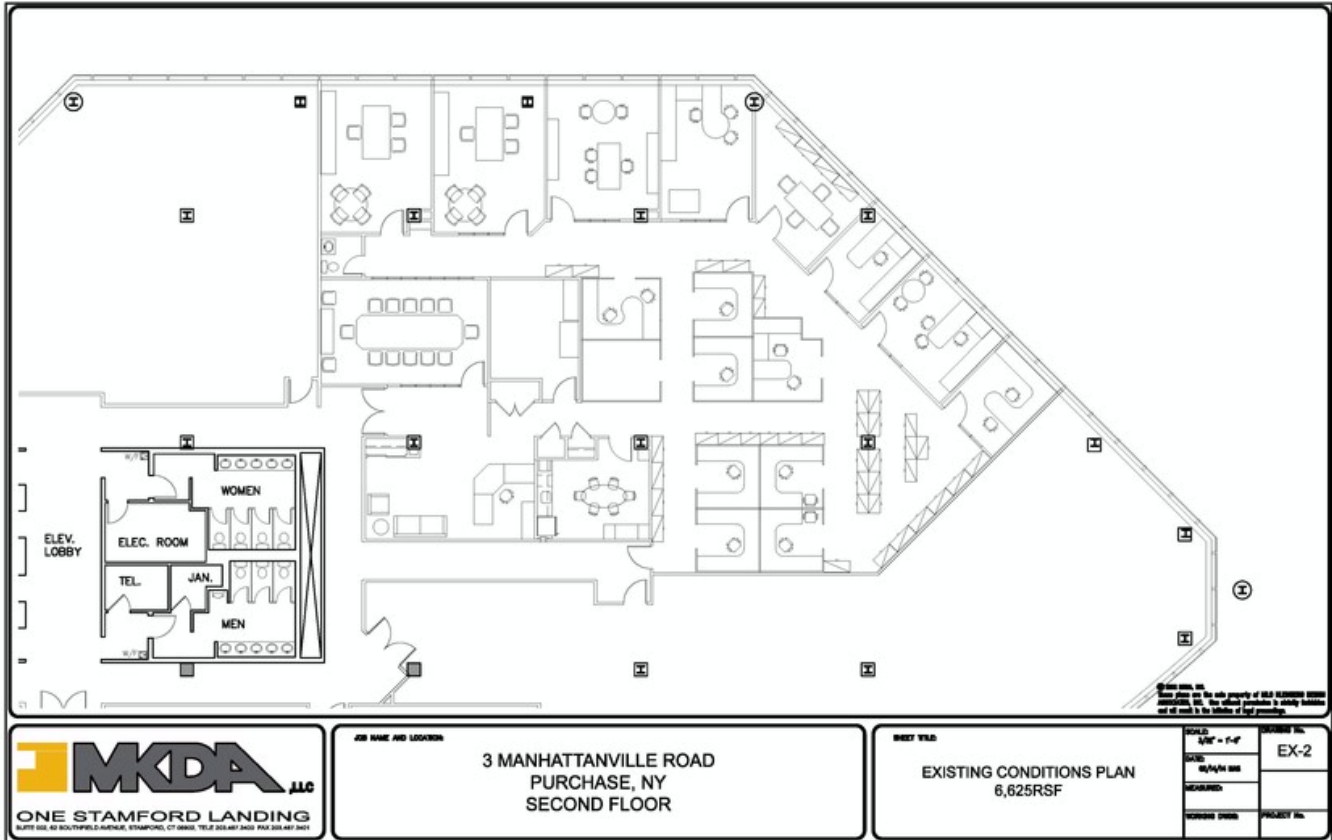

MKDA INC
ONE STAMFORD LANDING
SUITE 100, 80 SOUTHFIELD AVENUE, STAMFORD, CT 06901, TEL: 203.487.2400 FAX: 203.487.2401

JOB NAME AND LOCATION
3 MANHATTANVILLE ROAD
PURCHASE, NY
SECOND FLOOR

SHEET TITLE
EXISTING CONDITIONS PLAN
8,625RSF

SCALE 1/8" = 1'-0"	PROJECT NO. EX-2
DATE 02/04/14	
REVISIONS	
ISSUED FOR	